

Location: Duxford, Cambridgeshire
Budget: £3.25m housing
Date: 2015~
Status: Early strategic design

Duxford Brewery Field

housing development site, adjacent to
our proposed Community Hub

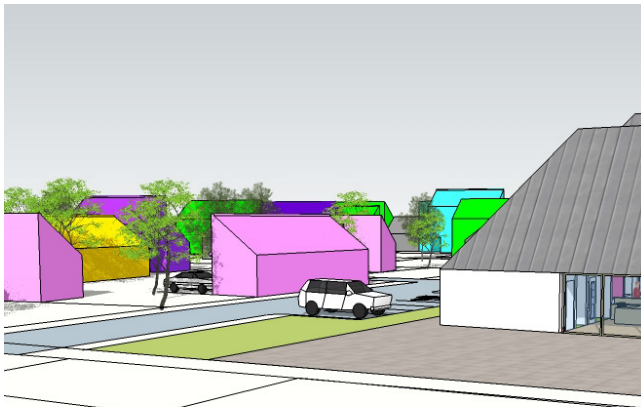
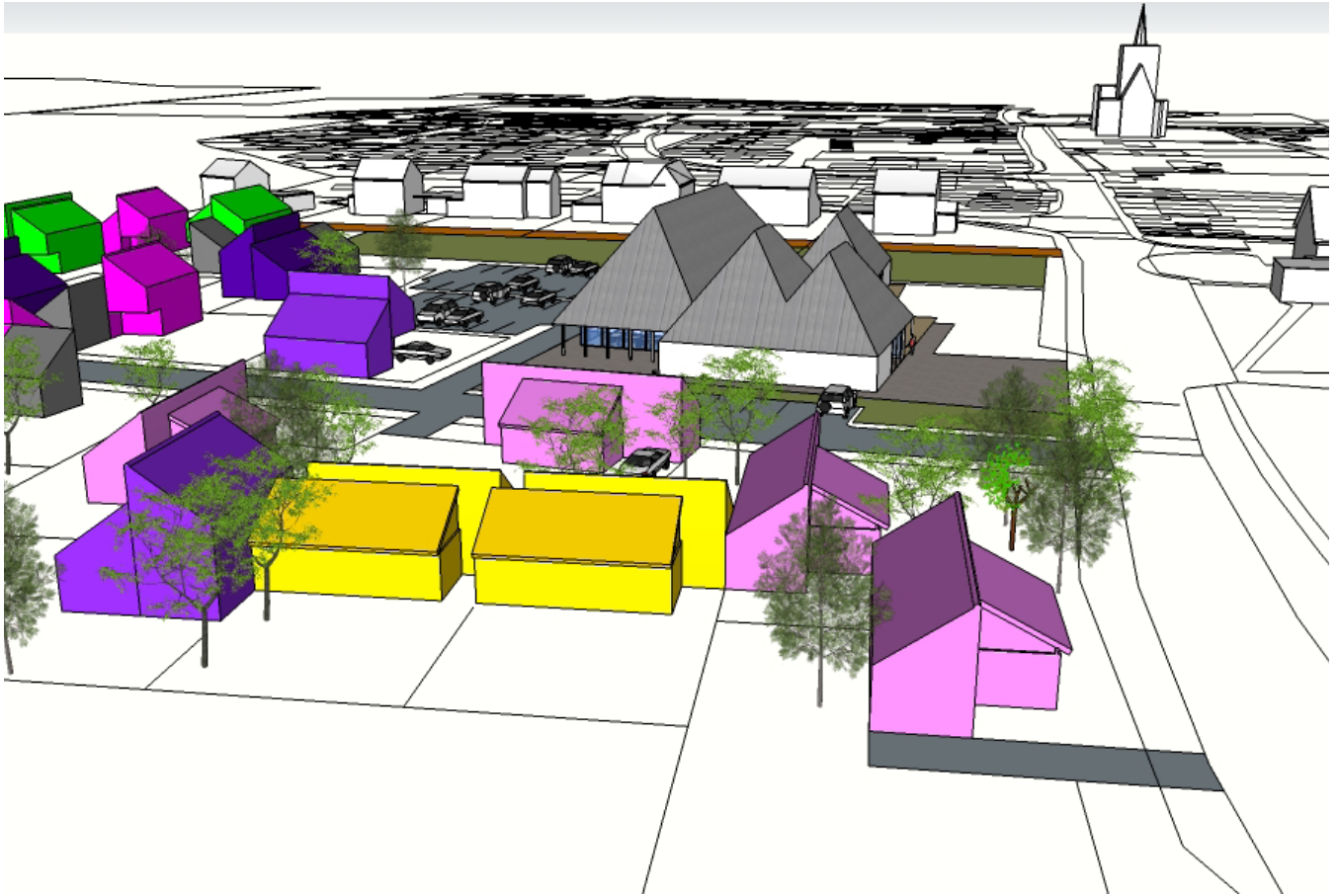

Alongside the design and community engagement activities that civic have been undertaking for Duxford Parish Council, we were asked to develop a schematic housing plan in order to attract potential housing developers to the site.

We worked on the financial modelling and design layouts to provide a commercially viable scheme that would provide opportunity for the village to expand sensitively and in line with demand for a range of housing types and tenures - thereby supporting the village's need to grow in a balanced way.



The housing scheme offers a variety of properties from 1 bed to 5 bed houses to create a mixed development of 22 units of various size wrapped around the new community hub and opposite the Primary School.

Following a village-wide referendum on the project for the community hub in 2015, the plans are on hold. A second village-wide referendum is due to be held in 2016.